

P/Q500 Solenoid

"P500 (pull type) and Q500 (push type) are built to withstand high temperature and high vibration environments."



P/Q500 Solenoids are used for locking, cutting and motion controls and are available in a variety of base sizes. Trombetta can customize any products to meet specific requirements so you can have them built exactly how you need them. P/Q500 options include various voltages, mounts, rods, boots spring returns, connectors and plunger surface finishes.

Field-proven performance: P500 (pull type) and Q500 (push type) electric solenoids use technology proven in a variety of applications such as valve actuation, off road equipment and packaging machines.

 **TROMBETTA • TYMPANIUM**

 **INDUSTRIAL DIESEL PRODUCTS INC.**
worldwide procurement solutions

Engineering Excellence. Worldwide Competitiveness.

P/Q500 Industrial Work Solenoid Specifications

Series	Stroke	Max Force	A Inches [mm]	B Inches [mm]	C Inches [mm]
P/Q514	1 1/2	130	3.00 [76.2]	2.55 [57.2]	Length Variable
P/Q515	2	190	3.60 [91.4]	2.63 [66.8]	Length Variable
P/Q516	2 1/2	220	4.30 [109.2]	3.00 [76.2]	Length Variable
P/Q517	3	280	5.00 [127.0]	3.50 [88.9]	Length Variable

General Specifications

Please refer to our website www.trombetta.com for general specifications.

Please refer to our website www.trombetta.com for force curves.

TROMBETTA SOLENOID CONTROLS

Trombetta Electronic Controls regulate the magnitude of electrical drive applied to the coil during the pull-in and hold operation of the solenoid to optimize the performance of the solenoid. Using solenoid controls can show the benefit of employing smaller solenoids, maximizing space use.

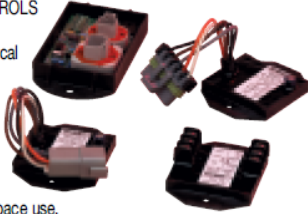

TYPICAL DIMENSIONS

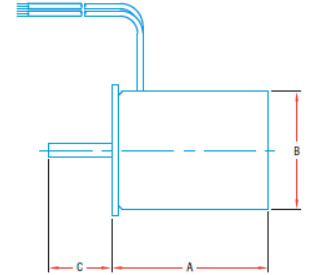
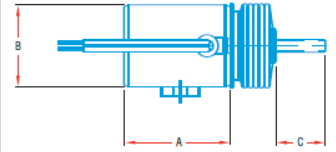

P517



Q516